



## How to contact us

Write to: Manor House, Church Street,  
Littlehampton, West Sussex, BN17 5EW

Email: [lrc@littlehampton-tc.gov.uk](mailto:lrc@littlehampton-tc.gov.uk)

Call: 01903 732063

Find us online: [www.littlehampton-tc.gov.uk](http://www.littlehampton-tc.gov.uk)

22 December 2021

Notice is hereby given that there will be a meeting of the:

### **Planning and Transportation Advisory Group**

**Venue:** Virtual meeting

**Date:** Tuesday 4 January 2022

**Time:** 6.30pm

#### **Committee:**

Councillor Long – Chair

Councillor Buckland

Councillor Tandy

Councillor Tilbrook

Councillor Turner

Councillor Woodman

**Peter Herbert, Town Clerk**

### **Agenda**

In accordance with the decision made by Full Council on 29 April 2021, the Advisory Groups will be meeting in place of Committees. In all respects other than the final decision, they will act as Committees but delegate decisions to the Town Clerk. This is to maintain access and transparency whilst restrictions on public gatherings remain.

### **2021 to 2022**

#### **Virtual Meeting Protocol**

This meeting will be a 'virtual meeting' and any member of the press and public may listen in and view the proceedings via a weblink which will be publicised on the Town Council website at least 24 hours before the meeting.

Any members of the public wishing to address the Council or any of its Committees during the Public Forum or seeking further information on the items to be discussed, will need to email [lrc@littlehampton-tc.gov.uk](mailto:lrc@littlehampton-tc.gov.uk) one clear working day before the meeting and provide details of their question.

## **1. Mobile Phones**

Members are requested to switch their mobile devices to silent for the duration of the meeting and are asked to note the previously approved protocol for remote meetings which is in place for the duration of this meeting.

## **2. Apologies**

## **3. Declarations of interest**

Members and Officers are reminded to make any declaration of disclosable pecuniary or personal and/or prejudicial interests that they may have in relation to items on this Agenda.

You should declare your interest by stating:

- a. the item you have the interest in
- b. whether it is a disclosable pecuniary interest, whereupon you will be taking no part in the discussions on that matter, or
- c.
  - i. whether it is a personal interest and the nature of the interest
  - ii. whether it is also a prejudicial interest
  - iii. If it is a prejudicial interest, whether you will be exercising your right to speak under Public Forum

It is recorded in the register of interests that:

- Councillor Buckland is a Member of Arun District Council
- Councillor Tilbrook is a Member of Arun District Council

These interests only need to be declared at the meeting if there is an agenda item to which they relate.

## **4. Minutes**

To confirm the Minutes of the meeting held on 6 December 2021, circulated herewith, pages 4 to 10 In accordance with the Town Councils' Standing Orders, Section 9a, Members are reminded that no discussion of the draft minutes of a preceding meeting shall take place except in relation to their accuracy.

## **5. Chair's Report and Urgent Items**

## **6. Public Forum**

Any members of the public wishing to address the Council or any of its Committees during remote meetings should email [lrc@littlehampton-tc.gov.uk](mailto:lrc@littlehampton-tc.gov.uk) one clear working day before the meeting with their submission. These will be read out by the Chair or a supporting officer at the meeting. During this period, and to enable the Council to answer as many questions as possible at the meeting, the submission should not exceed 200 words. The Clerk, in consultation with the Chair of the meeting, reserves the right to summarise written questions. All written questions and responses will be made available on the Town Council web site alongside the meeting minutes.

**7. Planning and other Arun District Council Matters**

**7.1. Planning Applications** – Lists 49, 50, 51 and 52 if available, attached, page 11

**7.2. Planning Application LU/315/21/PL – 12 Cornwall Road**

To receive and consider the attached a revised Site Plan which now shows 5 car parking spaces on site, instead of only 2. In light of this update the Advisory Group is also invited to reconsider its previous response to this planning application – attached for information at pages 12 to 14.

**7.3. Fitzalan Acoustic Barrier** – to note the attached representation made at the District Council's Planning Committee meeting on 15 December 2021 – pages 15 to 16

**8. Transportation and other West Sussex County Council Matters**

**8.1. Fitzalan Link Road – 30mph speed limit request** – to note the attached correspondence forwarded to the County Council – page 17

**8.2. Traffic Regulation Order Consultation** – to consider and comment upon the attached proposed Order relating to the Littlehampton Town Centre Regeneration Scheme – pages 19 to 36

**9. Masterplan – North Littlehampton**

**10. Exempt Business**

It is **Recommended** that:

**The public and accredited representatives of the press be excluded from the Meeting under Section 100 Local Government Act 1972 due to the confidential nature of the business to be conducted.**

**Minutes** of a Meeting of the **Planning and Transportation Committee** held in  
**The New Millennium Chamber, The Manor House, Church Street,**  
**Littlehampton BN17 5EW on Monday 6 December 2021 at 6.30pm**

**Present:**

Councillor Buckland – Vice Chair in the Chair  
Councillor Tandy  
Councillor Tilbrook  
Councillor Turner  
Councillor Woodman

**2021 to 2022**

**80. Evacuation Procedures**

The evacuation procedures were noted.

**81. Filming of Council Meetings, Use of Social Media and Mobile Phones**

The procedures were noted.

**82. Apologies**

There were apologies from Councillor Long.

**83. Declarations of Interest**

Members and Officers were reminded to make any declarations of disclosable pecuniary or personal and/or prejudicial interests that they might have in relation to items on the Agenda. The standing declarations were noted.

Councillor Tilbrook declared a personal interest in agenda item 8.1, Planning Applications, as a Member of Arun District Council's Planning Committee. He confirmed that when considering the planning applications for Littlehampton, he would do so without predetermination, taking into account the papers that were before him at that meeting.

#### **84. Minutes**

The Minutes of the meeting held on 8 November 2021, previously circulated, were confirmed as a true record and signed by the Chair.

#### **85. Chair's Report and Urgent Items**

##### **Proposed Fort Road Parking Restrictions – Traffic Regulation Order**

The Committee received details of a Traffic Regulation Order – copy attached to the Minutes – which, if implemented, would see the introduction of double yellow lines prohibiting waiting at any time on both sides of the highway at the junction of Fort Road, with Fort Road East. Members proceeded to consider the application in terms of the impact of the change on users of the Town Council's Ford Road allotment site and the potential displacement of vehicles in the surrounding area. The impact on the allotments was thought to be small as most users were local and as ever it was considered that this type of restriction was only effective if it was backed up with enforcement. Acknowledging that the application aimed to improve road safety the Committee therefore **Resolved**:

**Not to object to the Traffic Regulation Order and  
that the Committees' comments be forwarded to  
the County Council.**

#### **86. Public Forum**

##### **86.1. There were no public present.**

Councillor Turner declared a personal interest in the following matter as member of Protect Coastal England, an organisation aligned with the Campaign for the Protection of Coastal Sussex.

##### **86.2. The Committee received two written representations relating to the proposed development of the Rampion 2 Windfarm. The first was from the Littlehampton Society and the East Beach Residents Association regarding the Rampion 2 Wind Farm consent process. The committees of both groups wished to ensure that Members had the opportunity to take note and be aware of outcomes from the community-led public meeting on the Rampion 2 consultation and the recent the National Energy Policy Framework consultation. The second was from the Littlehampton Society which sought to make Members aware of a new group, the Campaign for the Protection of Coastal Sussex which would maintain a watching brief on the progress of the Rampion 2 proposals and offer regular updates.**

##### **86.3 These representations were received and noted by the Committee. Members also recalled that the District Council were commissioning an impact assessment and acknowledged that this would also be a valuable source of information regarding the impact of the development. It was noted that Members would contact these groups direct if they wished to receive their updates.**

## **87. Planning and Other District Council Matters**

### **87.1. Planning Applications – Lists 45, 46, 47 and 48**

It was **Resolved** that:

**The representations of the Council, appended to these Minutes as Appendix 1, be forwarded to Arun District Council.**

### **87.2. Planning Application LU/252/21/PL – 6 Selbourne Place, Littlehampton**

The Committee was requested to review its response to this application in light of the comments from the District Council's Houses in Multiple Occupation Officer, previously circulated. In his response to the application, he had highlighted that whilst the accommodation did meet the minimum standards, it was still lacking in other aspects, namely bathroom provision and windows. It also showed that whilst planning could be approved, this did not guarantee that a Houses in Multiple Occupation license would be granted. This emphasised the importance of engagement in the licensing process for Members of the Committee and it was agreed that this be raised with the District Council. Overall, Members still had significant concerns about the provision in relation to bathrooms and windows and the Committee therefore **Resolved** to:

**Maintain its objection to the application and that the comments set out in Minute 87.2. above be forwarded to the District Council.**

### **87.3. Fitzalan Acoustic Barrier**

It was noted that a Special Meeting of the District Council's Planning Committee had been called to consider consultant reports regarding the barrier. The Town Council had been invited to make a representation which could be in person or written. The meeting was scheduled to take place on 15<sup>th</sup> December 2021, but the agenda and report had yet to be published. In view of the timescale, it was agreed that the report be circulated to the Committee as soon as it was available and comments collated. It was therefore **Resolved** that:

**Authority be delegated to the Town Clerk, in consultation with the Chair, to agree the Committees' response and forward it to the District Council.**

## **88. Review of Strategic Aims and Objectives**

The Committee received a report, previously circulated, which set out the Town Council's strategic policies, aims and objectives as they related to the remit of the Committee. These had recently been reviewed to ensure they were relevant and reflected the Priorities of Council. Members proceeded to review theses in more detail and the following updates were noted:

- Connections to the new developments in North Littlehampton would be considered as part of any community and or bus service initiatives.
- The Council would only look to update the Neighbourhood Plan if, through working with the District Council, further sites were identified that both agreed were appropriate for residential development.
- The Heritage Group continued to work on their project regarding updating conservation area statements in the parish.

These did not affect the overarching aims and objectives as they related to the work of the Committee and no further changes were proposed. It was therefore **Resolved** that:

**Council be recommended to adopt the Aims and Objectives as they related to the work of this Committee.**

## **89. Transportation and West Sussex County Council Matters**

### **89.1. Ford Circular Technology Park, Ford Road, Ford BN18 0XL**

The Committee received an update from the County Council confirming that the above planning application had been withdrawn – previously circulated. It was **Resolved** that:

**The update be noted.**

## **90. Masterplan – North Littlehampton**

### **90.1. Planning Application LU/369/21/RES – Central Wetland Area Hampton Park Toddington Lane Littlehampton BN17 7PL**

The Committee had before it details of a planning application, previously circulated, which set detailed proposals for the design of the central wetland area of Hampton Park including the spine road and crossing structures. Reviewing the plans Members were supportive of the proposals and considered them to be vital to the success of the development that would provide a valuable and attractive leisure amenity for residents and the wider community in the future. It was therefore **Resolved** that:

**The application be supported, and the Committee's views be forwarded to the District Council.**

## **91. Committee Budget Proposals 2022 to 2025**

- 91.1.** The Committee received a report, previously circulated, which set out the draft Planning and Transportation Committee Budget for the three years covering 2022 to 2025 as well as the Earmarked Reserves that related to this Committee. It was **Resolved** that:

- 1. The draft Committee budget for 2022 to 2023 and the projected budgets for 2023 to 2024 and 2024 to 2025 be approved and the proposals be Recommended to the Policy and Finance Committee.**

**2. The Committee's Earmarked Reserve position  
be noted.**

**92. Exempt Business**

There was none.

The meeting closed at 7.40 pm.

---

**CHAIR**



## Appendix 1

### LITTLEHAMPTON TOWN COUNCIL Planning & Transportation Committee 6 December 2021 Representation on Lists 45, 46, 47, 48

Plan List No.	Ward	Ward Councillor	Planning No.	Details of Application	Location	Comments
45	Beach	BW	LU/343/21/HH	Part demolition of garage, single storey side extension and pitched roof to match existing house	2 Fairway Littlehampton BN17 6PY	No objection
46	Beach	BW	LU/360/21/CLP	Lawful development certificate for the proposed amend to the type of material and colour of the finishes of the existing approval LU/131/20/PL.	15 South Terrace Littlehampton	No objection
46	River	IB	LU/346/21/HH	Erection of first floor rear extension including 1 x rear juliet balcony and alterations to ground floor rear fenestration/openings.	47 St Marys Close Littlehampton BN17 5QE	No objection
46	River	IB	LU/340/21/PL	Application for works to existing building including; Insertion of new windows and rooflights, infilling of windows, replacement of window with Juliet balcony door and replacement of roofs and new coping to flint wall. This application is in CIL Zone 4 and is zero rated as other development.	The Old Printworks 7 Arundel Road Littlehampton BN17 7BY	Objection: on the grounds that the works would have an adverse impact on the residential amenity of the neighbouring property by virtue of the close proximity, overlooking and loss of privacy and windows opening out on to neighbours' residences.
46	River	IB	LU/358/21/CLP	Lawful development certificate for a proposed single storey rear extension.	12 St Marys Gardens Littlehampton	No objection
46	Wickbourne	JL/FT	LU/350/21/PL	Retention of solar PV panels on roof of employment units. This site is in CIL Zone 4 (Zero Rated) as other development.	Units 33-36 on Land at Lineside Industrial Estate Northwest Eldon Way Littlehampton BN17 7HE	No objection
46	Wickbourne	JL/FT	LU/362/21/HH	Erection of single storey side/rear extension including the installation of 2 x rooflights to pitched roof.	1 North Ham Road Littlehampton BN17 7AR	No objection

## Appendix 1

### LITTLEHAMPTON TOWN COUNCIL Planning & Transportation Committee 6 December 2021 Representation on Lists 45, 46, 47, 48

Plan List No.	Ward	Ward Councillor	Planning No.	Details of Application	Location	Comments
47	River	IB	LU/359/21/PL	Change of use from C2 residential to an HMO (Sui Generis) (resubmission following LU/124/21/PL. This application may affect the setting of a listed building and may affect the East Street, Littlehampton Conservation Area.	18-22 East Street Littlehampton BN17 6AW	No objection. Whilst the committee had no objection on planning grounds, members still had significant concerns about the adequacy of the facilities particularly bathrooms & parking should the premises be licenced to their potential full capacity of 22. The committee therefore requested that these factors be carefully considered as part of the licencing process.
47	Wick	JL/FT	LU/364/21/HH	Erection of single storey rear extension following the demolition of existing rear conservatory	23 Blakehurst Way Littlehampton BN17 6HE	No objection
48	Beach	BBC	LU/384/21/HH	Single storey rear extension following demolition of existing rear extension.	18 Middle Mead Littlehampton BN17 6QH	No objection
48	Beach	BW	LU/380/21/PL	Replacement of 1 No PVCu window with a timber window to the rear (East) elevation. This application may affect the setting of a listed building, affects the Littlehampton Sea Front Conservation Area & is in CIL Zone 4 (Zero Rated) as other development.	Regency Court Nursing Home 18-20 South Terrace Littlehampton BN17 5NZ	Supported
48	Beach	BW	LU/381/21/L	Listed building consent for the replacement of 1 No PVCu window with a timber window to the rear (East) elevation.	Regency Court Nursing Home 18-20 South Terrace Littlehampton BN17 5NZ	Supported
48	Brookfield	AT	LU/375/21/CLP	Lawful development certificate for a proposed side extension.	39 Westlands Rustington	No objection

## Appendix 1

### LITTLEHAMPTON TOWN COUNCIL Planning & Transportation Committee 4 January 2022 Representation on Lists 49, 50, 51, 52

Plan List No.	Ward	Ward Councillor	Planning No.	Details of Application	Location	Comments
49	River	MM	LU/383/21/PL	Workshop extension (resubmission following LU/216/21/PL). This site is in CIL Zone 5 (Zero Rated) as other development.	9 North Street Littlehampton BN17 6JJ	
50	Courtwick with Toddington	JL/FT	LU/206/21/RES	Amended description received 9/12/21 Approval of reserved matters following outline consent LU/47/11/ for the development of 261 No. dwellings, the formation of green swale (SuDs feature) and the construction of part of the Central Spine Road running through Phase 5 at Hampton Park and southwards to link up with Toddington Lane. This site is in CIL zone SP2 and is not CIL Liable as strategic site.	Phase 5 Hampton Park Toddington Lane Littlehampton BN17 7PL	
51	River	IB	LU/405/21/HH	Single storey side extension and new roof to existing extension.	42 Cornwall Road Littlehampton BN17 6EQ	



Arun District Council  
Arun Civic Centre  
Maltravers Road  
Littlehampton  
West Sussex BN17 5LF  
Planning & Building Control General Enquiries  
Tel: (01903) 737756 Fax: (01903) 730442  
Dx: 57406 Littlehampton  
Minicom: 01903 732765  
e-mail: [planning@arun.gov.uk](mailto:planning@arun.gov.uk)  
website: [www.arun.gov.uk/planning](http://www.arun.gov.uk/planning)

12th November 2021

The Town Clerk  
Littlehampton Town Council  
The Manor House  
Church Street  
Littlehampton  
BN17 5EW

**Case Officer:** Amy Myer  
**Telephone:** 01903 737776  
**Email:** [amy.myer@arun.gov.uk](mailto:amy.myer@arun.gov.uk)

Dear Sir/Madam,

**Town & Country Planning Act 1990 (as amended)**  
**Town and Country Planning (Development Management Procedure) (England) Order 2015**

Application No: LU/315/21/PL  
Site Address: 12 Cornwall Road Littlehampton BN17 6EE  
Description of works: Change of use from (C3) Dwelling house to 7 bed House in Multiple Occupation (Sui Generis) including the demolition of the existing garage and erection of single storey side extension (resubmission following LU/240/21/PL). This site is in CIL Zone 4 and is CIL Liable as a House in Multiple Occupation.

Thank you for your internet representation made on 11th November 2021 which has been recorded as an objection with the comments as follows:

OWPC41827

The Town Council's Planning and Transportation Advisory Group considered this application at their meeting held on Monday 8 November 2021 and object to the application. The Committee acknowledged the steps that had been taken to reconfigure the internal space and that the accommodation met the internal space standards. However, Members considered that despite the Comments from WSCC Highways, the proposals, by virtue of the position of the site and lack of parking provision and onsite turning space, were unsafe and would constitute an adverse impact on the residential amenity of those living in the surrounding area.

Your views as made above will be considered before the application is determined.

Please be aware that Planning Services operate an 'open file' policy and will publish your comments including your name and address on the website. Please make sure that you have only provided information that you are happy will be published in this way. If you have supplied information belonging to a third party, you must make sure you have their permission to do so. If you do not wish your comments to appear on the website or on the file you will need to confirm this by emailing to [planning@arun.gov.uk](mailto:planning@arun.gov.uk) and I will arrange for it to be destroyed although this means that the content will then be disregarded.

The majority of applications are determined under delegated powers by officers. Further information on the decision making process can be found on the website at <https://www.arun.gov.uk/what-happens-next>.

Some applications will be determined by the Planning Committee, and I shall write and inform you of the date of the meeting and the procedures for public speaking if this is the case. However, if your representation has been received after the agenda for the meeting has been finalised and the notifications have been generated, you will not receive notification. In this case, you will need to track the progress of the application on the council's website <https://www.arun.gov.uk/planning-application-search>

Any comments that are received after the agenda has been finalised will be separately reported to the members of the Planning Committee.

Regardless of how the application is determined I will notify you of the decision.

Yours sincerely



**Neil Crowther**  
**Group Head of Planning**

For details of how the Council will deal with your data please refer to our privacy notices on the website <https://www.arun.gov.uk/privacy-policy/>

**If you have provided an email address, all correspondence including the decision notice will be sent by email. It is therefore important that you keep us informed if this changes during the course of this application.**

**To register to receive notification of planning applications in your area, please go to**  
<https://www1.arun.gov.uk/planning-application-finder>

CORNWALL ROAD

ARUNDEL ROAD

NOTE  
DO NOT SCALE FROM THIS DRAWING. ALL DIMENSIONS  
RELATING TO SUB-CONTRACTORS OR SUPPLIERS WORK MUST  
BE CHECKED AND AGREED BETWEEN THE GENERAL  
CONTRACTOR AND THE SUB-CONTRACTORS AND SUPPLIERS.  
ALL DIMENSIONS ARE IN MILLIMETRES. IF IN DOUBT ASK THIS  
DRAWING MAY BE SCALED FOR PLANNING PURPOSES ONLY. ALL  
WORKS OR MATERIALS INDICATED ON THE DRAWING ARE TO BE  
TO THE LATEST BRITISH STANDARDS AND ARE TO BE CARRIED  
OUT IN ACCORDANCE WITH THE RELEVANT CODES OF PRACTICE  
OR RECOGNIZED TRADE ASSOCIATION RECOMMENDATIONS  
AND PUBLICATIONS. © THIS DRAWING IS THE COPYRIGHT OF  
FUNNELL DESIGN PARTNERSHIP LTD.

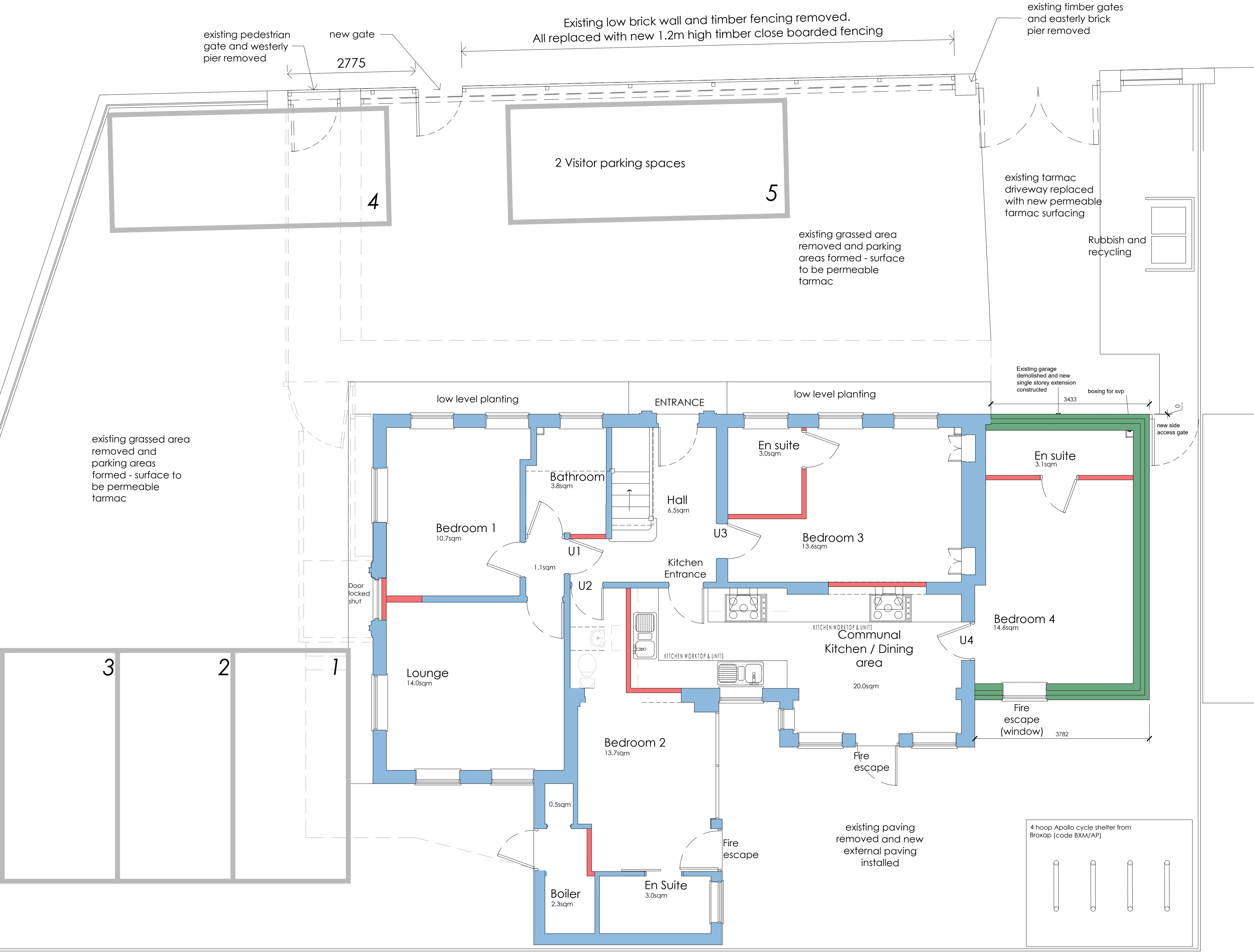
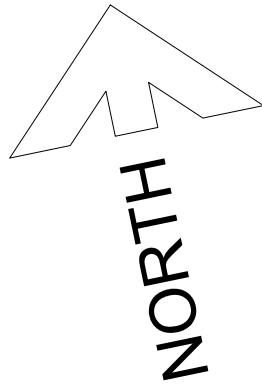

D	27/11/21	JF	External entry door to Unit 4 removed, External boundary fence and vehicle entry amended.
C	01/10/21	JF	External parking increased from 2 spaces to 5.
B	10/08/21	JF	Ground floor building layout updated.
A	15/06/21	JF	Existing garage shown removed and replaced with new single storey structure.
-	22/04/21	JM	2no. external door openings infilled due to amended internal layout.
			Drawing created
REV	DATE	BY	DESCRIPTION



**FUNNELL DESIGN PARTNERSHIP**

BizSpace, Courtwick Lane, Littlehampton, BN17 7TL  
T: +44 (0)1243 211250 - E: office@funnelldesign.co.uk

Client  
IVAN TIHOMIR PROPERTIES LTD

Location  
12 Cornwall Road  
Littlehampton, BN17 6EE

Drawing Title  
Proposed Site Plan

Date April 2021	Drawn By DB	Scale 1:50 @ A1
CAD file name 12 Cornwall Road - PLANNING Rev07.dwg		
Drawing No 2350-P-04	Revision D	

Proposed Site Plan  
Scale 1:50



---

Mr Neil Crowther  
Group Head of Planning  
Arun District Council  
Civic Centre  
Maltravers Rd  
Littlehampton  
West Sussex BN17 5LF

14 December 2021

Dear Mr Crowther

**Written submission for Planning Committee – 15<sup>th</sup> December 2021 re: The  
Fitzalan Link Road Acoustic Barrier, Littlehampton**

Thank you to the District Council for convening this meeting and inviting us to make a representation.

On behalf of the Town Council's Planning and Transportation Committee, I would like to begin by thanking the District Council for commissioning a further report on this import matter and our appreciation for the coherent way in which the findings have been presented.

It is clear from the report that a reduction in the height of the current barrier from 3.5m to 2.5m is the only realistic option, especially as the acoustic report, paragraph 3.20, states that this would result in a "minimum perceptible" increase in the level of noise. We therefore support the principle of reducing the height of the barrier and in reaching this conclusion I would add that we do not believe that relocating the barrier is a realistic option due to the disruption this would cause for neighbouring properties and the need to maintain the unimpeded operation of traffic on this new key route in and out of the town.

The strength of public opinion regarding the height of the barrier remains such that we believe that residents would wish to see the local planning and highways authorities work together to address this issue. It would also be best if the developer were engaged in any further discussions as they are on site and have the inhouse expertise to conduct any further works. Clearly, there are complex legal issues that would need to be resolved for this to happen.

Page 1 of 2

We acknowledge however that this will require further work to determine costs and how such an alteration in the height of the fence could be accomplished. We therefore support the recommendation in the report that is before the Planning Committee proposing pursuing a formal modification of the planning permission through an order under Section 102/103 of the Town and Country Planning Act 1990.

We also remain committed to seeing the overall speed limit on the link road reduced to 30mph and now that it is open, we will be writing to the County Council urging them to begin monitoring traffic and initiate the necessary review.

Yours sincerely

**Councillor Jill Long**  
**Chair of Planning and Transportation Committee**

Page 2 of 2





## Littlehampton Town Council

Manor House • Church Street • Littlehampton • West Sussex BN17 5EW  
Telephone: 01903 732063 • Facsimile: 01903 731690  
[lrc@littlehampton-tc.gov.uk](mailto:lrc@littlehampton-tc.gov.uk) • [www.littlehampton-tc.gov.uk](http://www.littlehampton-tc.gov.uk)

---

Councillor Joy Dennis

Cabinet Office, County Hall  
Chichester  
West Sussex  
PO19 1RQ

20<sup>th</sup> December 2021

Dear Councillor Dennis

### **Speed limit on the Fitzalan Link Road, Littlehampton**

I am writing to you following the recent opening of the link road. You will recall our previous correspondence regarding the speed limit and our wish to see it reviewed as a priority. I also believe that the Head Teacher of the Littlehampton Academy has been in contact with the County Council following an accident involving one of their pupils which occurred within a few days of the new road opening.

It is fortunate that the pupil involved in the recent incident was not seriously injured but I hope you will agree that this demonstrates the urgent need for the speed limit to be reviewed. The incident highlighted the nature of the traffic that the Link Road will have to bear, and the volume will only increase as the planned North Littlehampton development grows. This is without taking into consideration that this highway will eventually provide continuity for the Lyminster Bypass.

I am therefore writing to urge you bring forward a review of the speed limit is an immediate priority with a view to reducing to 30mph the speed limit on this stretch of the road and to request that the review findings are shared with us as soon as they are available.

Yours sincerely

**Councillor Jill Long**  
**Chair of Planning and Transportation Committee**  
**Littlehampton Town Council**

Page left intentionally blank

# **TRAFFIC REGULATION ORDER (TRO) CONSULTATION**

## **JEA8016MM – Littlehampton Town Centre Regeneration Scheme**

**9/12/21 – 6/1/22**

### **Contents**

Notice	Page 2
Statement of Reasons	Page 3
Draft Moving Order	Page 4
Draft Parking Order	Page 9
Plan "1000007160-120-02-A" - proposals	Page 10
Plan "1000007160-120-03-C" - proposals	Page 11
Plan "1000007160-120-04-A" - proposals	Page 12
Plan "c_aruntq0201nen_2" - existing restrictions	Page 13
Plan "c_aruntq0201nen_2" – proposals	Page 14
Plan "c_aruntq0202ses_2" - existing restrictions	Page 15
Plan "c_aruntq0202ses_2" – proposals	Page 16
Plan "c_aruntq0301nwn" - existing restrictions	Page 17
Plan "c_aruntq0301nwn" – proposals	Page 18

**West Sussex County Council**  
**(Littlehampton: High Street and Various Roads)(Traffic Regulation) and**  
**(Consolidation) Order 2022**

**And**

**West Sussex County Council (Arun District) (Parking Places & Traffic**  
**Regulation) (Consolidation) Order 2010**

**(Littlehampton: Town Centre Public Realm Improvements Amendment) Order**  
**2022**

NOTICE is hereby given that West Sussex County Council proposes to make two permanent Traffic regulation Orders under the provisions of the Road Traffic Regulation Act 1984 as follows:

The first Order proposes to introduce a 20 MPH speed limit on East Street, from Anchor Springs to Beach Road, on Beach Road from East Street to New Road, and on High Street from Beach Road, eastwards for a distance of 25 metres.

This Order also prohibits any vehicle from driving on Duke Street from its junction with High Street northwards for a distance of 24 metres, and on St Martins Lane, from its junction with High Street, northwards for a distance of 24 metres. The Order also consolidates various other traffic restrictions on roads in the surrounding area for housekeeping purposes.

The second Order makes amendments to parking restrictions on various roads in Littlehampton town centre as part of a scheme of highway improvements changing junction layouts and widening pavements on Surrey Street, High Street, Beach Road and East Street. The Order makes the layout of existing parking bays on High Street at its junction with Arundel Road and on Beach Road between East Street and New Road.

Full details of the proposals in this notice can be viewed on the Traffic Regulation Order page of the West Sussex County Council website. The [website](#) includes a response form for any comments or objections.

Due to current social distancing requirements, paper copies of documents will not be available to view in council offices or libraries. People without access to a computer who wish to view details of the scheme should telephone the West Sussex County Council Contact Centre on 01243 642105 to receive the documents by post.

Any comments or objections about the proposal must be received before 6 January 2022. These may be submitted via the response form on the website mentioned above, by e-mail to [tro.consultation@westsussex.gov.uk](mailto:tro.consultation@westsussex.gov.uk) or in writing to TRO Team, West Sussex County Council, The Grange, Tower Street, Chichester, PO19 1RH. For legal reasons, only correspondence including a full name and address will be considered. Please quote reference JEA8016-MM in all correspondence.

Dated this 9th day of December 2021.  
Director of Law & Assurance, County Hall, Chichester.

**West Sussex County Council**  
**(Littlehampton: High Street and Various Roads)(Traffic Regulation) and**  
**(Consolidation) Order 2022**

**And**

**Sussex County Council (Arun District) (Parking Places & Traffic Regulation)**  
**(Consolidation) Order 2010**  
**(Littlehampton: Town Centre Public Realm Improvements) Order 2022**

**Statement of Reasons for Proposing to Make the Orders**

West Sussex County Council proposes to make two permanent Traffic Regulation Orders as part of a major project of public realm improvements in Littlehampton town centre.

The first Order proposes to introduce a 20 MPH speed limit on East Street, from Anchor Springs to Beach Road, on Beach Road from East Street to New Road, and on High Street from Beach Road, eastwards for a distance of 25 metres. This restriction is part of a package of measures to improve the amenity of these roads for pedestrians.

This Order also prohibits any vehicle from driving on Duke Street from its junction with High Street northwards for a distance of 24 metres, and on St Martins Lane, from its junction with High Street, northwards for a distance of 24 metres. These restrictions extend the pedestrianised sections of roads at their junctions with High Street to improve amenity for pedestrians.

In addition to these new measures the Order also consolidates various other traffic restrictions on roads in the surrounding area for housekeeping purposes.

The second Order makes amendments to parking restrictions to accommodate changing junction layouts and widening pavements on Surrey Street, High Street, Beach Road and East Street. The Order changes the layout of existing parking bays on High Street at its junction with Arundel Road and on Beach Road between East Street and New Road.

These changes are intended to accommodate improvements to footways while maintaining the availability of on street parking, and access for loading for businesses in the area.

More information on the project is available at: [www.arun.gov.uk/la-public-realm](http://www.arun.gov.uk/la-public-realm)

The new order is therefore proposed to preserve or improve the amenities of the area through which the road runs.

The attached drawings, titled Littlehampton Town Centre Proposed Lining and Signing Sheet 2 of 4, Sheet 3 of 4 and Sheet 4 of 4 (Sheet 1 of 4 shows restrictions being installed at a later date) show an overview of the new restrictions being installed by the proposed Orders.

Drawing numbers TQ0201NEN, TQ0202SES and TQ0301NWN show the restrictions as they will appear in the new parking Order for the affected roads.

Director of Law & Assurance  
19 October 2021  
JEA8016-MM

**WEST SUSSEX COUNTY COUNCIL**  
**(LITTLEHAMPTON: HIGH STREET AND VARIOUS ROADS)**  
**(TRAFFIC REGULATION) AND (CONSOLIDATION)**  
**ORDER 2022**

West Sussex County Council in exercise of their powers under Section 84 (1) a of the Road Traffic Regulation Act 1984 ("the Act"), and after consultation with the chief officer of police in accordance with Part III and Part IV of Schedule 9 to the Act hereby make the following Order:-

1. This Order shall come into operation on the \*\*\*\*\* day of \*\*\*\*\* and may be cited as "West Sussex County Council (Littlehampton: High Street and Various Roads) (Traffic Regulation) and (Consolidation) Order 2022".

2. The Orders specified in the First Schedule to this Order are hereby revoked.

Interpretation

3. In this Order –

"Goods Vehicle" means a motor vehicle or trailer constructed or adapted for use for the carriage or haulage of goods or burden of any description.

"Pedal Cycle" means a unicycle, bicycle, tricycle or cycle having four or more wheels not being in any case mechanically propelled, unless it is an electrically assisted pedal cycle that is not treated as a motor vehicle for the purposes of The Act.

"vehicle" means any motor vehicle or pedal cycle.

"Public Service Vehicle" has the same meaning as in Section 1 of the Public Passenger Vehicles Act as Amended.

One Way Traffic

4. Save as provided by Articles 5 and 9, no person shall cause or permit any vehicle proceeding in a length of road specified in column 1 of the Second Schedule to this Order, to proceed in a direction other than specified in column 2 of the Second Schedule to this Order.
5. Nothing in Article 4 shall apply to a pedal cycle proceeding in a contraflow cycle system in accordance with authorised traffic signs.

Prohibition of Driving Except Goods Vehicles

6. Save as provided by Article 9, no person shall cause or permit any vehicle other than a goods vehicle proceeding for the purposes of loading or unloading, to proceed in the length of road specified in the Third Schedule to this Order.

Prohibition of Driving Except Public Service Vehicles

7. Save as provided by Article 9, no person shall cause or permit any vehicle other than a public service vehicle to proceed in the length of road specified in the Fourth Schedule to this Order.

Prohibition of Driving by All vehicles

8. Save as Provided by Article 9 no person shall cause or permit any vehicle to proceed in the length of road specified in the Fifth Schedule to this Order.

General Exemptions

9. Nothing in Articles 4, 6, 7 and 8 shall apply to:

- a) Any vehicle being used by the Police, Ambulance Service or Fire Brigade in the event of an emergency;
- b) Any vehicle directed to proceed in the affected length of road by a Police Officer in uniform.

#### 20 MPH Speed Limit

- 10. No person shall cause or permit any vehicle to travel at a speed exceeding 20 Miles Per Hour on any length of road specified in the Sixth Schedule to this Order.
- 11. The lengths of roads specified in the Sixth Schedule to this Order shall not be regarded as a restricted road for the purposes of Section 82(2) of the Act.
- 12. Nothing in Article 10 shall apply to a vehicle being used by naval, military or air force purposes while being driven by a person for the time being subject to the orders of a member of the armed forces of the Crown on an occasion when –
  - (a) the person driving the vehicle is a member of the special forces as defined by the Road Traffic Exemptions (Special Forces) (Variation and Amendment) Regulations 2011; and
  - (b) the vehicle is being driven-
    - (i) in response, or for practice in responding, to a national security emergency by a person who has been trained in driving vehicles at high speeds; or
    - (ii) for the purpose of training a person in driving vehicles at high speeds.

#### Width Restriction

- 13. Save as provided in Article 14, no person shall cause or permit any vehicle which, including any load it is carrying, measures greater than 6 feet 6 inches in width, to proceed in the length of road specified in the Seventh Schedule.
- 14. Nothing in Article 13 shall apply to:
  - (a) a vehicle being driven in order to load or unload to or from premises adjacent to the lengths of road specified in the Seventh Schedule; or
  - (b) a vehicle used in connection with any building operation or demolition in or on land adjacent to the roads in the Seventh Schedule, or for the removal of any obstruction to traffic in those roads or the laying erection, alteration or repair in or near to those roads of any sewer or of any main, pipe or apparatus for the provision of gas, water, electricity or telecommunications; or
  - (c) a vehicle being used by the Fire Brigade, Police or Ambulance Services in the event of an emergency.

**FIRST SCHEDULE**  
**Orders to be Revoked**

<b><u>Order Title</u></b>	<b><u>Part to be Revoked</u></b>
The Administrative County of West Sussex (Littlehampton: Various Roads) (Traffic Regulation) Order 1968	The Whole Order
The County Council of West Sussex (Littlehampton: High Street) (Prohibition of Driving) Order 1978	The Whole Order
The County Council of West Sussex (Littlehampton: St Martins Lane, Duke Street, Anchor Springs and Anchor Springs Service Area) (Prohibition of Waiting and One Way Traffic) Order 1979	The Whole Order
The County Council of West Sussex (Littlehampton: High Street (Part) Surrey Street (Part) and Duke Street Part)) (Prohibition of Driving and Width Restriction) Order 1979	The Whole Order
The County Council of West Sussex (Littlehampton: St Martins Bus Slip Road) (Prohibition of Driving) Order 1983	The Whole Order
The County Council of West Sussex (Littlehampton: East Street and High Street) (Traffic Regulation) Order 1993	The Whole Order
West Sussex County Council (Littlehampton: Duke Street) (One-Way Traffic and Revocation) Order 2004	The Whole Order

**SECOND SCHEDULE**  
**One Way Traffic**

<b><u>Column 1</u></b> <b><u>Length of Road</u></b>	<b><u>Column 2</u></b> <b><u>Permitted Direction of Travel</u></b>
Anchor Springs – from its junction with Duke Street to its junction with East Street	Eastwards
Arcade Road – from its junction with Beach Road to its junction with Clifton Road	Westwards
Bayford Road – from its junction with New Road to its junction with Arcade Road	Northwards
Beach Road- from its junction with High Street to its junction with New Road	Southwards
Beaconsfield Road – from a point 35 metres north of its junction with North Street, to a point 40 metres south east of its junction with Wick Street	Northwards



Clifton Road – from its junction with Arcade Road to its junction with High Street	Northwards
Duke Street – from its junction with Franciscan Way to its junction with Anchor Springs	Southwards
East Street – from its junction with Church Street to its junction with High Street	Southwards
High Street – from its junction with Surrey Street to its junction with Arundel Road	Westwards
High Street – from the western kerbline of Clifton Road to its junction with Beach Road	Eastwards
Pier Road – from its junction with New Road to its junction with Surrey Street	Northwards
River Road – from its junction with Terminus Road to its junction with Terminus Place	South-eastwards
St Martins Road – from its junction with Arundel Road eastwards for a distance of 32 metres	Eastwards
Surrey Street – from its junction with Pier Road to its junction with High Street	Northwards

### **THIRD SCHEDULE** **Prohibition of Vehicles Except Goods Vehicles**

<b><u>Road in Littlehampton</u></b>	<b><u>Affected length of Road</u></b>
Clifton Road	From its junction with High Street, southwards for a distance of 25 metres
High Street	From the western kerbline of its junction with Clifton Road, eastwards to its junction with East Street

### **FOURTH SCHEDULE** **Prohibition of Vehicles Except Public Service Vehicles**

<b><u>Road in Littlehampton</u></b>	<b><u>Affected length of Road</u></b>
St Martins Road	From its junction with Arundel Road, eastwards for a distance of 32 metres

**FIFTH SCHEDULE**  
**Prohibition of All Vehicles**

<b><u>Road in Littlehampton</u></b>	<b><u>Affected length of Road</u></b>
High Street	From its junction with Surrey Street, eastwards to the western kerblin of Clifton Road
Duke Street	From its junction with High Street, northwards for a distance of 24 metres
St Martins Lane	From its junction with High Street, northwards for a distance of 24 metres

**SIXTH SCHEDULE**  
**20 MPH Speed Limit**

<b><u>Road in Littlehampton</u></b>	<b><u>Affected length of Road</u></b>
East Street	From its junction with Anchor Springs, southwards to its junction with Beach Road
Beach Road	From its junction with East Street, southwards to the roundabout at its junction with New Road
High Street	From its junction with Beach Road, eastwards for a distance of 25 metres

**SEVENTH SCHEDULE**  
**6ft 6ins Width Restriction**

<b><u>Road in Littlehampton</u></b>	<b><u>Affected length of Road</u></b>
Duke Street 1361	From a point 40 metres north of its junction with High Street, southwards to its junction with High Street

THE COMMON SEAL of WEST SUSSEX  
COUNTY COUNCIL was hereto affixed )  
the            day of            2022        )  
in the presence of:                        )  
    )  
    )  
    )  
    )  
    )  
Authorised Signatory                        )

File No: JEA8016-MM

**WEST SUSSEX COUNTY COUNCIL**  
**((ARUN DISTRICT) (PARKING PLACES & TRAFFIC REGULATION)**  
**(CONSOLIDATION) ORDER 2010)**

**(LITTLEHAMPTON: TOWN CENTRE PUBLIC REALM IMPROVEMENTS**  
**AMENDMENT) ORDER 2022**

West Sussex County Council in exercise of their powers under Sections 1 (a) 2 (1) and (2), 4 (2), 45. 46. 49 and 53 and Part IV of Schedule 9 of the Road Traffic Regulation Act 1984 ("the Act") as amended and of all other enabling powers and after consultation with the Chief Officer of Police in accordance with Part III of Schedule 9 to the Act hereby make the following Order:-

1. The Order shall come into operation on the \*\*\*\*\* day of \*\*\*\*\* 2022 and may be cited as "West Sussex County Council) ((Arun District) (Parking Places & Traffic Regulation) (Consolidation) Order 2010) (Littlehampton: Town Centre Public Realm Improvements Amendment) Order 2022".
2. The "West Sussex County Council ((Arun District) (Parking Places & Traffic Regulation) (Consolidation) Order 2010" is hereby amended by the replacement of the plans specified in the First Schedule to this Order, with the plans specified in the Second Schedule, attached hereto.

**FIRST SCHEDULE**  
**Plans to be Replaced**

TQ0201NEN (Issue Number 5)  
TQ0202SES (Issue Number 4)  
TQ0301NWN (Issue Number 1)

**SECOND SCHEDULE**  
**Replacement Plans**

TQ0201NEN (Issue Number 6)  
TQ0202SES (Issue Number 5)  
TQ0301NWN (Issue Number 2)

THE Common Seal of THE	)
WEST SUSSEX COUNTY COUNCIL	)
Was hereto affixed the	)
	)
day of	)
2022	)
	)
	)
	)
Authorised Signatory	)
JEA8016-MM	)





LEGEND

- Proposed Sign Unit including new sign face and metal post
- Existing Sign Retained (post or lamp post mounted)
- Reflective Fold Down 'Flecta' Bollard

Notes

Drawing to be read in conjunction with:  
Drawings 1000007160-121-01 PROPOSED SIGN SCHEDULE  
All signs and road markings to be in accordance with the Traffic Signs Regulations and General Directions 2016.

Positioning and locations to be in accordance with the guidance provided in the Department of Transport Traffic Signs Manual.

Materials, processes and quality of workmanship employed in the installation of signing and marking to be in accordance with the Specification for Highway Works.

Proposed signs face edge to be 450mm set back from carriageway edge.

Proposed signs not shown as mounted on metal posts are proposed to be mounted on existing Street Lighting columns, mounting height to be 2300mm.

Contractor to take down 7014 Signs after 3 months of completion of the works.

SAFETY, HEALTH AND ENVIRONMENTAL INFORMATION

In addition to the hazards/risks normally associated with the type of work detailed on this drawing, note the following significant risks and information identified by the designer.

- ▲ CONSTRUCTION  
No significant hazards
- ▲ DEMOLITION  
No significant hazards
- ▲ MAINTENANCE & OPERATION  
No significant hazards

It is assumed that all works be carried out by a competent contractor working, where appropriate, to an approved method statement.

Rev	Date	Description	KG	RH	GW
A	22.06.21	STAGE 4 ISSUE			

This drawing has been specifically prepared to meet the requirements of the named client and may contain design and innovative features which differ from conventional design standards.



38 Foundry Street  
Brighton  
BN1 4AT  
Tel: 01273 056 122  
Mail: info@projectcentre.co.uk  
Web: www.projectcentre.co.uk

Client



Project

LITTLEHAMPTON TOWN CENTRE

Drawing Title

PROPOSED LINING AND SIGNING  
SHEET 2 OF 4

Drawing Status

STAGE 4

Drawn	Designed	Date	Scale	Size
LG	KG	20.05.21	1:250	A1
Drawing No.				Rev
1000007160-120-02				A



KEY PLAN:

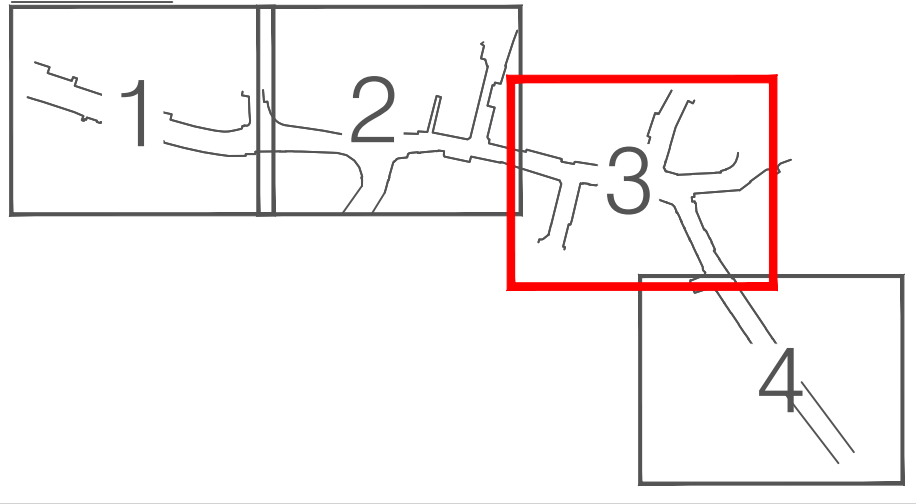

CUT LINE TO SHEET 3C

INDENT 3C

PS29 to be temporarily mounted on lighting column.

**NEW ROAD LAYOUT AHEAD**

Sign To be mounted on existing lighting column.

CUT LINE TO INDENT 3

LEGEND

- Proposed Sign Unit including new sign face and metal post
- Existing Sign Retained (post or lamp post mounted)
- Reflective Fold Down "Flecta" Bollard

Notes

Drawings to be read in conjunction with:  
Drawings 1000007160-121-01 PROPOSED SIGN SCHEDULE

All signs and road markings to be in accordance with the Traffic Signs Regulations and General Directions 2016.

Positioning and locations to be in accordance with the guidance provided in the Department of Transport Traffic Signs Manual.

Materials, processes and quality of workmanship employed in the installation of signing and marking to be in accordance with the Specification for Highway Works.

Proposed signs face edge to be 450mm set back from carriageway edge.

Proposed signs not shown as mounted on metal posts are proposed to be mounted on existing Street Lighting columns, mounting height to be 2300mm.

Contractor to take down 7014 Signs after 3 months of completion of the works.

SAFETY, HEALTH AND ENVIRONMENTAL INFORMATION

In addition to the hazards/risks normally associated with the type of work detailed on this drawing, note the following significant risks and information identified by the designer

▲ CONSTRUCTION

--- No significant hazards

▲ DEMOLITION

--- No significant hazards

▲ MAINTENANCE & OPERATION

--- No significant hazards

It is assumed that all works be carried out by a competent contractor working, where appropriate, to an approved method statement.

Rev	Date	Description	Drm	Chk	App
C	13.08.2021	LOADING ROUTE TIME RESTRICTIONS REMOVED	KG	RH	GW
B	09.08.2021	LOADING ROUTE TIME RESTRICTIONS ADDED	KG	RH	GW
A	22.06.21	STAGE 4 ISSUE	KG	RH	GW

This drawing has been specifically prepared to meet the requirements of the named client and may contain design and innovative features which differ from conventional design standards.

**PROJECT CENTRE**  
part of Marston Holdings  
**EDBURTON**

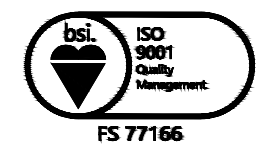

38 Foundry Street  
Brighton  
BN1 4AT  
Tel: 01273 056 122  
Mail: info@projectcentre.co.uk  
Web: www.projectcentre.co.uk

Client



Project

LITTLEHAMPTON TOWN CENTRE

Drawing Title

PROPOSED LINING AND SIGNING  
SHEET 3 OF 4

Drawing Status



**STAGE 4**

Drawn	Designed	Date	Scale	Size
LG	KG	20.05.21	1:250	A1
Drawn No.	1000007160-120-03	Rev	C	

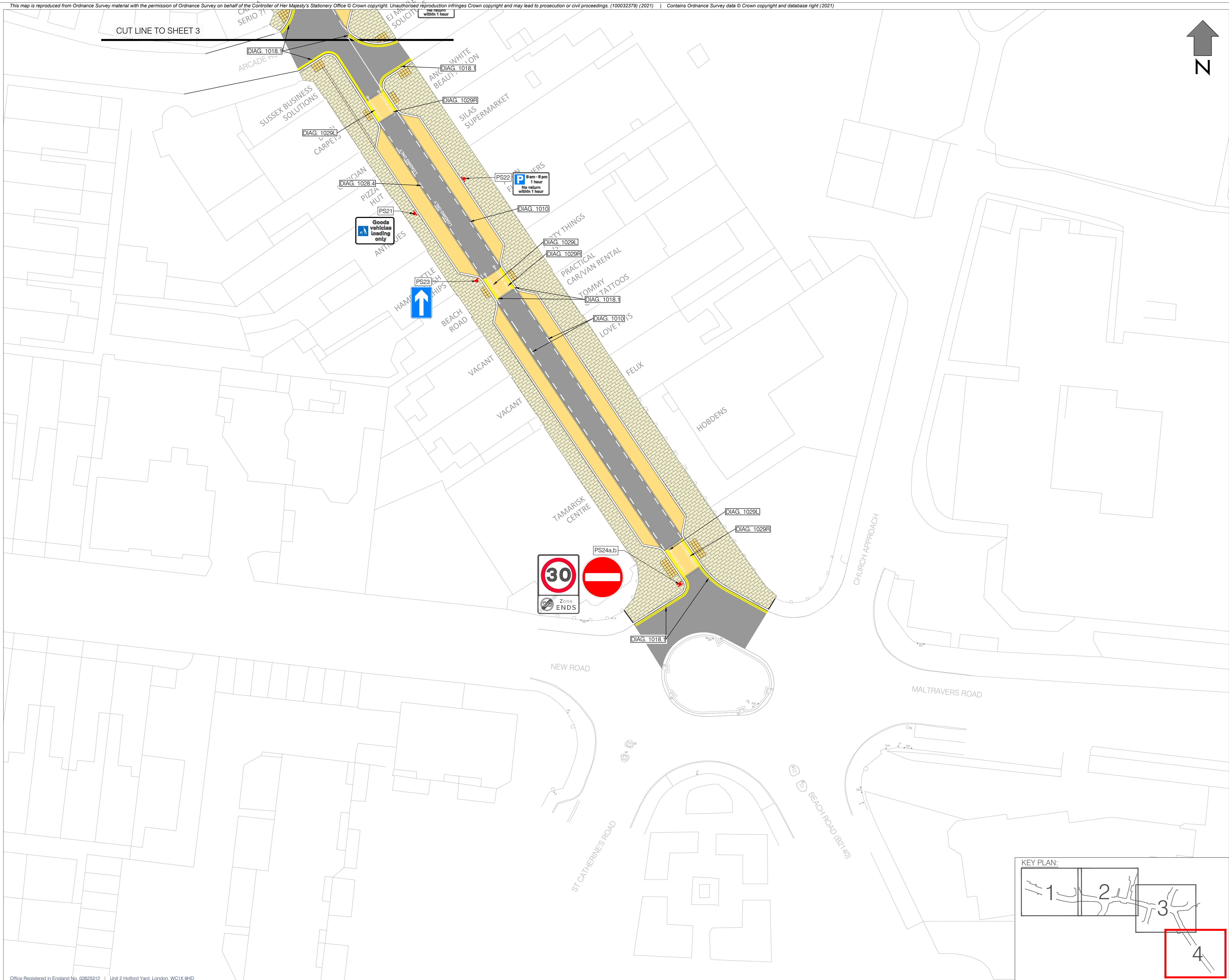



### LEGEND

- |  |   |
|--|---|
|   | Proposed Sign Unit including new sign face and metal post |
|   | Existing Sign Retained (post or lamp post mounted)        |
|  | Reflective Fold Down "Flecta" Bollard                     |

## Notes

Drawing to be read in conjunction with:  
Drawings 1000007160-121-01 PROPOSED SIGN SCHEDULE

All signs and road markings to be in accordance with the Traffic Signs Regulations and General Directions 2016.

Positioning and locations to be in accordance with the guidance provided in the Department of Transport Traffic Signs Manual.

Materials, processes and quality of workmanship employed in the installation of signing and marking to be in accordance with the Specification for Highway Works.

Proposed signs face edge to be 450mm set back from carriageway edge.

Proposed signs not shown as mounted on metal posts are proposed to be mounted on existing Street Lighting columns, mounting height to be 2300mm.

Contractor to take down 7014 Signs after 3 months of completion of the works.

## SAFETY, HEALTH AND ENVIRONMENTAL INFORMATION

In addition to the hazards/risks normally associated with the type of work detailed on this drawing, note the following significant risks and information identified by the designer

**CONSTRUCTION**  
---- No significant hazards

**DEMOLITION**  
---- No significant hazards

**⚠ MAINTENANCE & OPERATION**  
---- No significant hazards

It is assumed that all works be carried out by a competent contractor working, where appropriate, to an approved method statement.

Rev	22.06.2021	STAGE 4 ISSUE	KG	RH	GW
	Date	Description	Drn	Chk	App

This drawing has been specifically prepared to meet the requirements of the named client and may contain design and innovative features which differ from conventional design standards.



**PROJECT CENTRE**  
part of Marston Holdings  
**EDBURTON**



38 Foundry Street  
Brighton  
BN1 4AT  
Tel. 01273 056 122  
Mail. [info@projectcentre.co.uk](mailto:info@projectcentre.co.uk)  
Web. [www.projectcentre.co.uk](http://www.projectcentre.co.uk)

Client



Project

LITTLEHAMPTON TOWN CENTRE

Drawing Title

PROPOSED LINING AND SIGNING  
SHEET 4 OF 4

Drawing Status

## STAGE 4

Drawn LG	Designed KG	Date 20.05.21	Scale 1:250	Size A1
Drawing No. 1000007160-120-04				Rev A



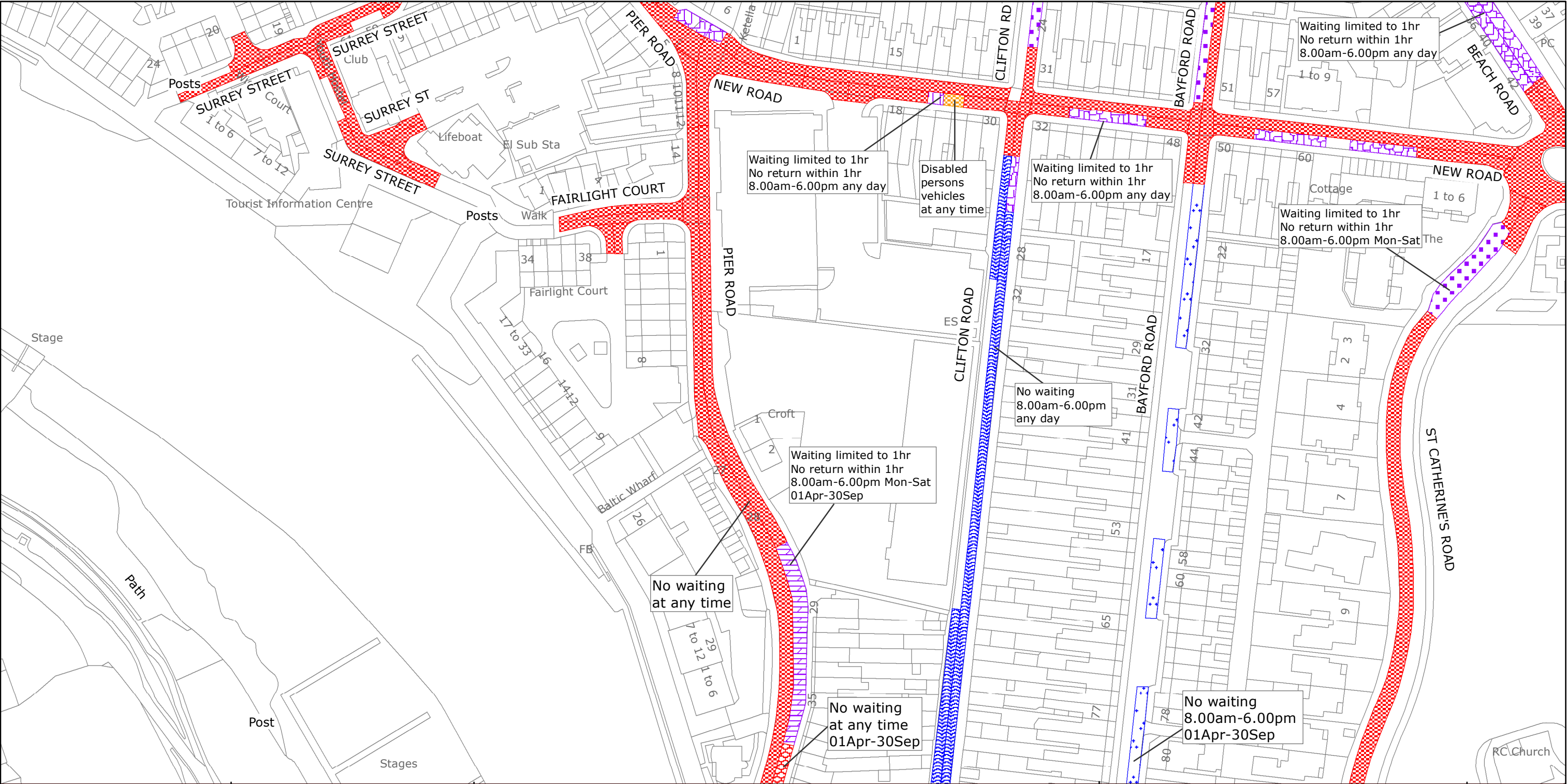

West Sussex County Council  
Highways & Transport  
The Grange  
Tower Street  
Chichester  
West Sussex  
PO19 1RH

ARUN DISTRICT: LITTLEHAMPTON  
WAITING RESTRICTIONS

Reproduced from or based upon 2018 Ordnance Survey mapping with permission of the Controller of HMSO (c) Crown Copyright reserved.  
Unauthorised reproduction infringes Crown copyright and may lead to prosecution or civil proceedings West Sussex County Council Licence No. 100018485

TILE REF NO:  
TQ0201NEN

SHEET ISSUE NO 5  
SHEET ACTIVE FROM - 09/07/2018

N  
  
SCALE:  
1:1250  
at A3 size

PAGE 2 OF 2: PROPOSED CHANGES TO RESTRICTIONS (CIRCLED)

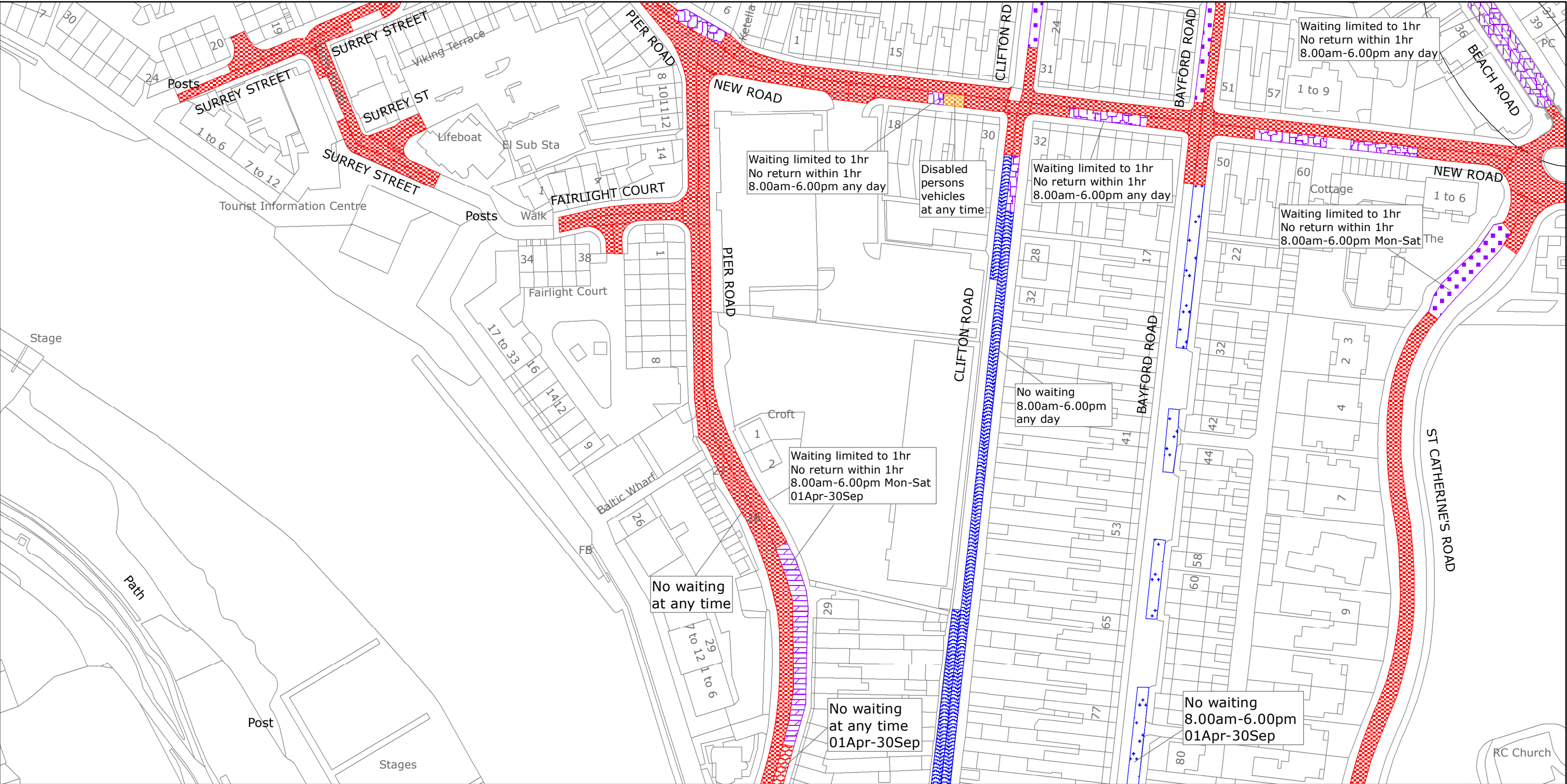

	<p>West Sussex County Council Highways &amp; Transport The Grange Tower Street Chichester West Sussex PO19 1RH</p>	<p>ARUN DISTRICT: LITTLEHAMPTON</p> <p>PROPOSED WAITING RESTRICTIONS (10.11.2021)</p>	<p>TILE REF NO: TQ0201NEN</p>	<p>N</p> <p>SCALE: 1:1250 at A3 size</p>
<p>Reproduced from or based upon 2021 Ordnance Survey mapping with permission of the Controller of HMSO (c) Crown Copyright reserved. Unauthorised reproduction infringes Crown copyright and may lead to prosecution or civil proceedings West Sussex County Council Licence No. 100018485</p>			<p>SHEET ISSUE NO 6_JEA8016P1 SHEET ACTIVE FROM - DD.MM.YYYY</p>	



PAGE 1 OF 2: EXISTING RESTRICTIONS ONLY

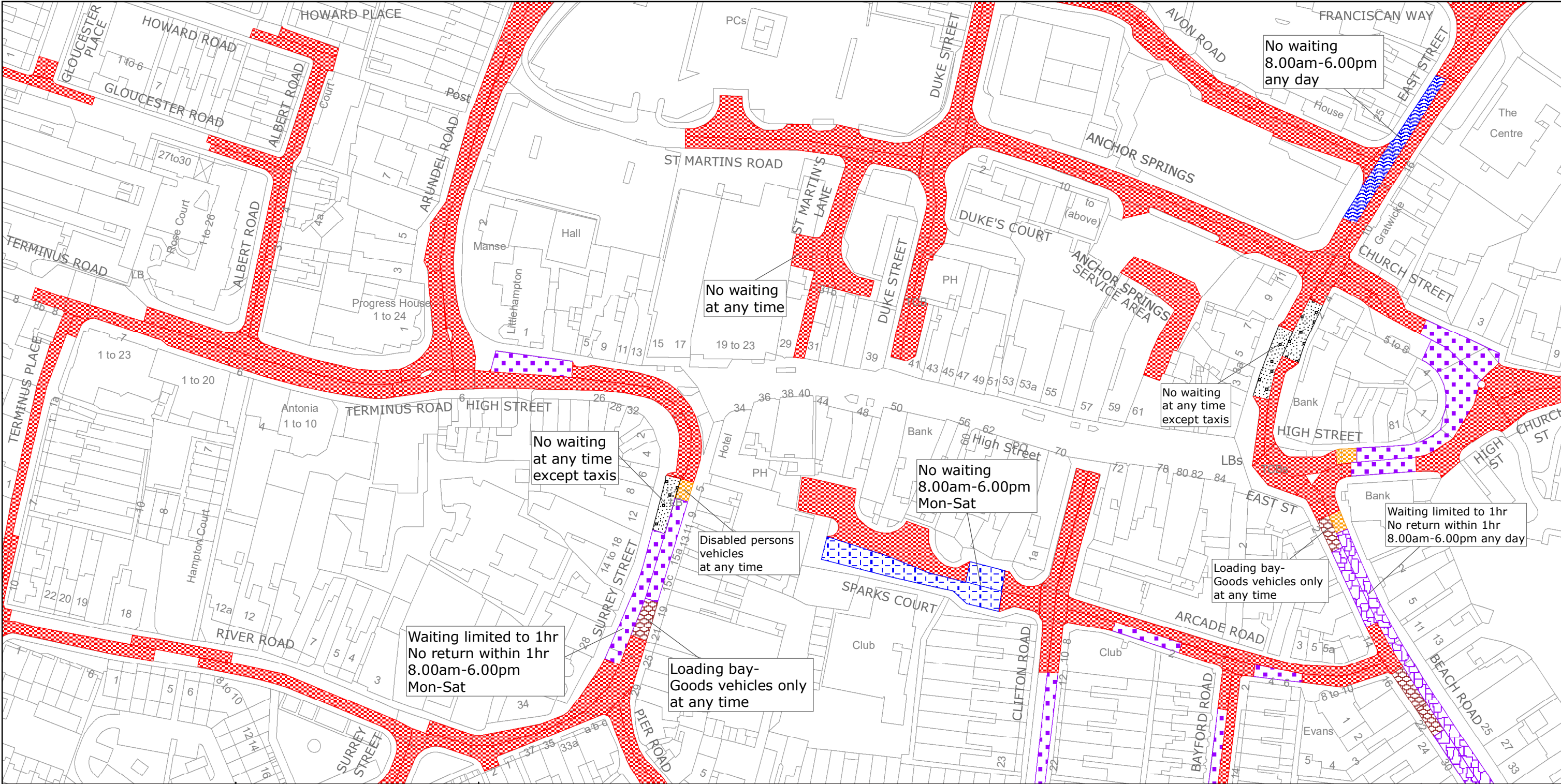

West Sussex County Council  
Highways & Transport  
The Grange  
Tower Street  
Chichester  
West Sussex  
PO19 1RH

ARUN DISTRICT: LITTLEHAMPTON  
WAITING RESTRICTIONS

Reproduced from or based upon 2013 Ordnance Survey material with permission of the Controller of HMSO (c) Crown Copyright reserved.  
Unauthorised reproduction infringes Crown copyright and may lead to prosecution or civil proceedings West Sussex County Council Licence No. 100023447

TILE REF NO:  
TQ0202SES

SHEET ISSUE NO 4  
SHEET ACTIVE FROM - 30/05/2016

N  
SCALE:  
1:1250  
at A3 size



PAGE 2 OF 2: PROPOSED CHANGES TO RESTRICTIONS (CIRCLED)

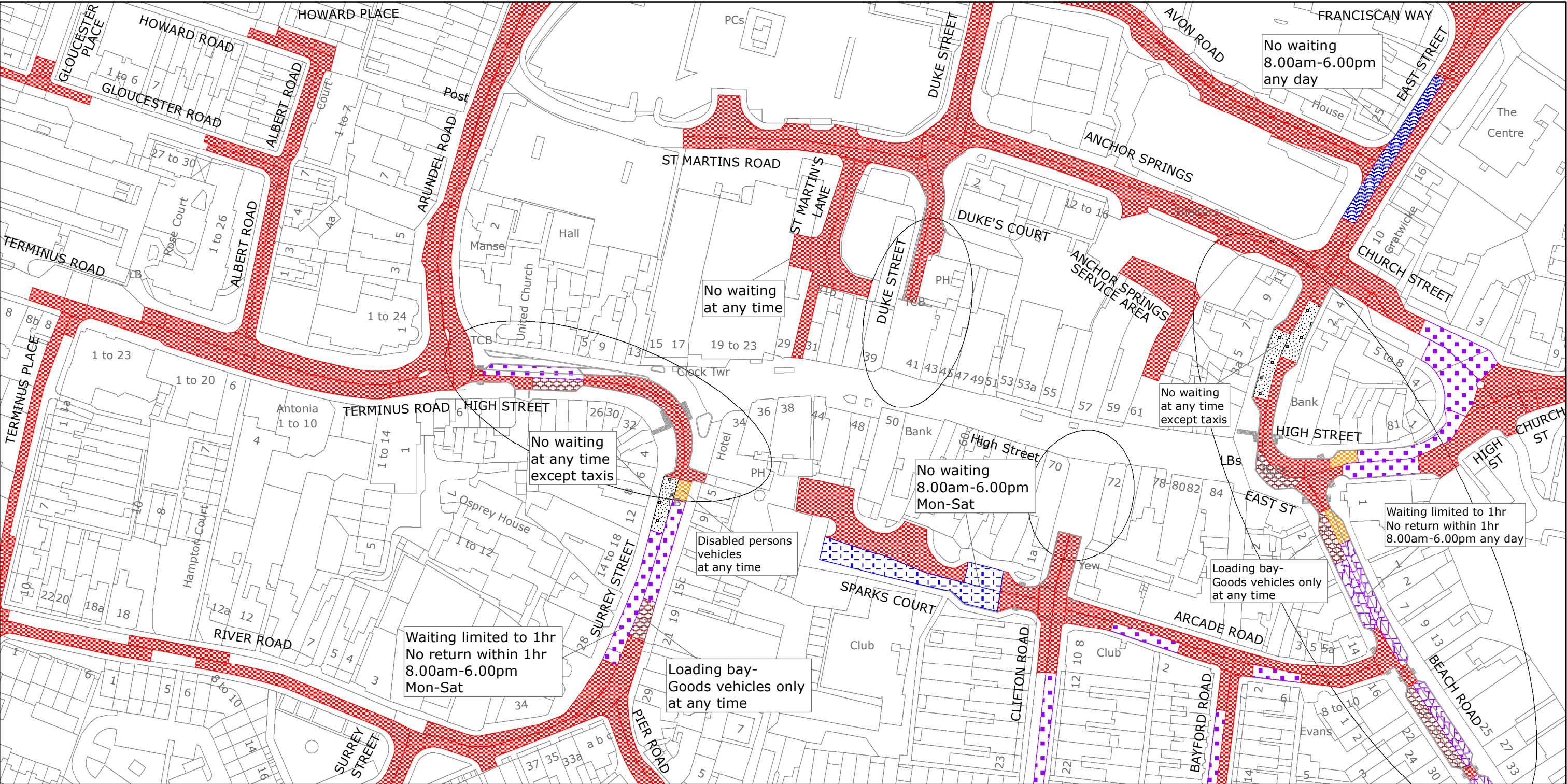

PAGE 1 OF 2: EXISTING RESTRICTIONS ONLY

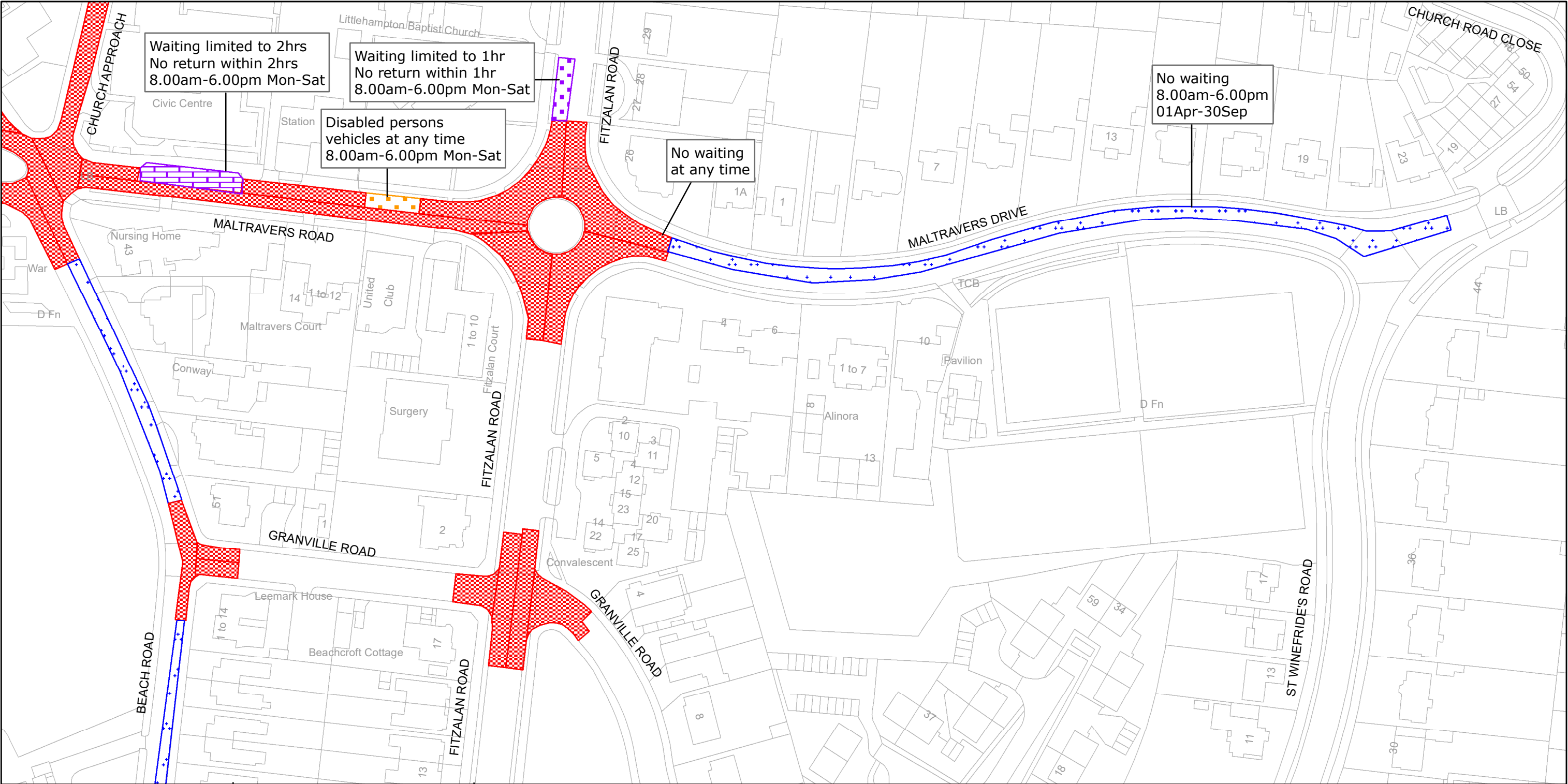

 <p>West Sussex County Council Infrastructure The Grange Tower Street Chichester West Sussex PO19 1RH</p>	<p>ARUN DISTRICT: LITTLEHAMPTON</p> <p>WAITING RESTRICTIONS</p> <p><small>Reproduced from or based upon 2009 Ordnance Survey mapping with permission of the Controller of HMSO (c) Crown Copyright reserved. Unauthorised reproduction infringes Crown copyright and may lead to prosecution or civil proceedings West Sussex County Council Licence No. 100023447</small></p>	<p><b>TILE REF NO:</b> <b>TQ0301NWN</b></p> <p>SHEET ISSUE NO 1</p> <p>SHEET ACTIVE FROM - 05/07/2010</p>	 <p>SCALE: 1:1250 at A3 size</p>
--	--	---	---



PAGE 2 OF 2: PROPOSED CHANGES TO RESTRICTIONS (CIRCLED)

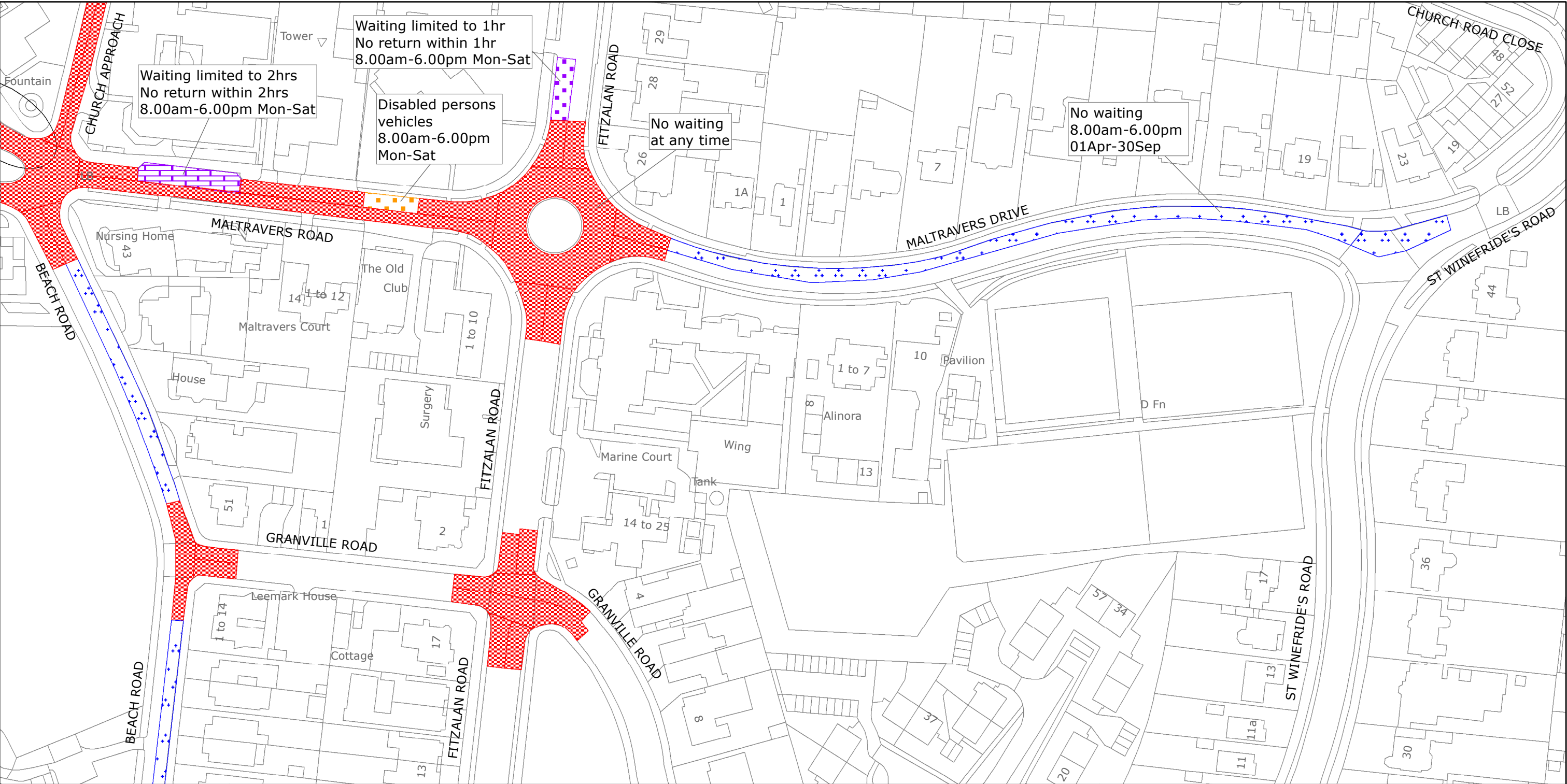

West Sussex County Council  
Highways & Transport  
The Grange  
Tower Street  
Chichester  
West Sussex  
PO19 1RH

ARUN DISTRICT: LITTLEHAMPTON  
PROPOSED WAITING RESTRICTIONS (27.08.2021)

Reproduced from or based upon 2021 Ordnance Survey mapping with permission of the Controller of HMSO (c) Crown Copyright reserved.  
Unauthorised reproduction infringes Crown copyright and may lead to prosecution or civil proceedings West Sussex County Council Licence No. 100018485

TILE REF NO:  
TQ0301NWN

SHEET ISSUE NO 2\_JEA8016P1  
SHEET ACTIVE FROM - DD.MM.YYYY

N  
SCALE:  
1:1250  
at A3 size